

Parts book

Product type
MQP-25-S Serie 2



Den Hoek 10
5845 EL St. Anthonis
the Netherlands
Telephone +31 (0)485 442300
Fax +31 (0)485 442120

info@demarec.com
www.demarec.com



*Copyright Demolition and Recycling Equipment BV
All rights strictly reserved.
Reproductions to third parties in any form whatever is not permitted
without written authority from the proprietor*

Partsbook_403640-02.doc

Multi Quick Processor

Page	1	of	2
Date	April 2009		
Product type	MQP-25-S		
Number	MQP25S105BAA 403640-02		

Jaw Group

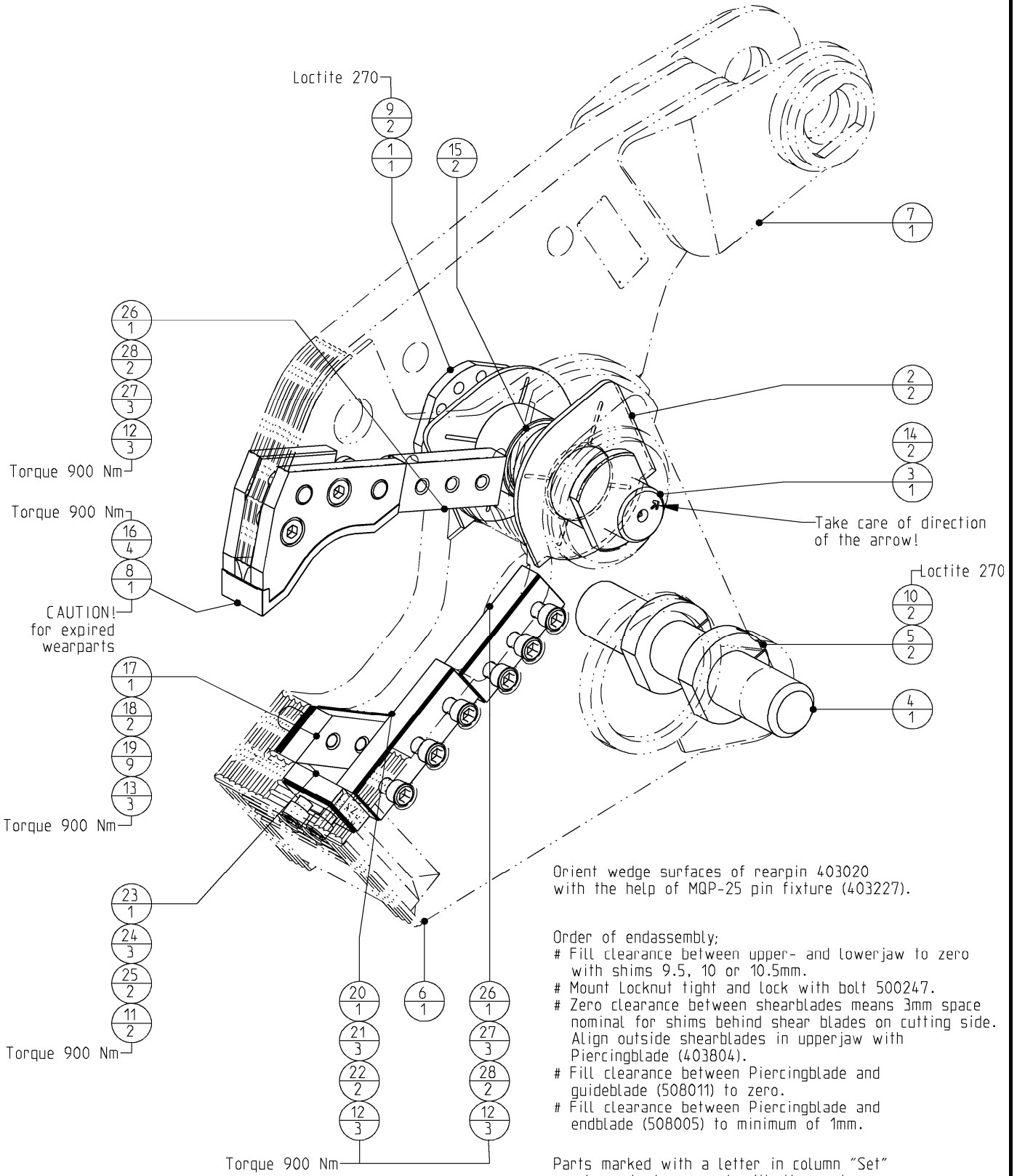

Parts marked with a letter in column "Set" can be ordered as a set with Itemnumber

Set	Wearpartset	Itemnumber	Expired
a	Cuttingedges set	402849	
b	Piercingblade set	403653	403650

Multi Quick Processor

Page	2	of	2
Date	April 2009		
Product type	MQP-25-S		
Number	MQP25S105BAA 403640-02		

Jaw Group

*□	8	403804 (1x)	508053 (1x) and 508054 (1x)	
Set	POS	CURRENT PART	EXPIRED PART	
* : EXPIRED PARTS				
a	28	508022	Shim - straight	4
a	27	508021	Shim - straight	6
a	26	508020	Shear - blade straight	2
a	25	508019	Shim - straight	2
a	24	508018	Shim - straight	3
a	23	508017	Shear - blade straight	1
a	22	508016	Shim - straight	2
a	21	508015	Shim - straight	3
a	20	508014	Shear - blade straight	1
a	19	508013	Shim - diamond	9
a	18	508012	Shim - diamond	2
a	17	508011	Shear - blade diamond	1
b	16	506022	Shoulder bolt	4
	15	500572	Bushing	2
	14	500560	Grease - nipple	2
a	13	500285	Hex. socket head cap screw	3
a	12	500283	Hex. socket head cap screw	9
	11	500281	Hex. socket head cap screw	2
	10	500262	Hex. socket head cap screw	2
	9	500247	Hex. socket head cap screw	2
*□	8	403804	Piercingblade asm.	1
	7	403641	Jaw - upper asm. machined	1
	6	403076	Jaw - lower asm. machined	1
	5	403021	Ring - clamp	2
	4	403020	Pin	1
	3	403019	Pin	1
	2	402105	Spacer	2
	1	402051	Locknut M110x4	1
Set	POS	PARTNUMBER	PARTNAME	QT